

Fields 1 to 10

BUSINESS 209

Monroe County Burnley Soccer Complex

FROM THE WEST: (Chateau Resort, Mt. Pocono)

TAKE I-80 EAST TO EXIT 302 (209 SOUTH / 33 SOUTH). TRAVEL ON ROUTE 33 SOUTH / MERGES WITH 209 SOUTH FOR 2 MILES. TAKE THE EXIT AFTER HWY MERGES. THE EXIT RAMP IS MARKED AS EXIT ONLY – LOOK FOR HARLEY DAVIDSON / EXXON STORE ON RIGHT. MAKE LEFT AT THE END OF RAMP AND FOLLOW SIGNS AND FIELD MAP.

FROM THE EAST: (From Fields 11-14, NJ, Ramada Inn, Stroudsburg Main Street)

TAKE I-80 WEST TO EXIT 304 (209 SOUTH / 33 SOUTH). TRAVEL 5 MILES TO MERGE WITH RTE 33 AND TAKE THE 1st EXIT AFTER THE MERGE. THE EXIT RAMP IS MARKED AS EXIT ONLY – LOOK FOR HARLEY DAVIDSON / EXXON STORE. MAKE LEFT AT END OF RAMP AND FOLLOW SIGNS AND FIELD MAP.

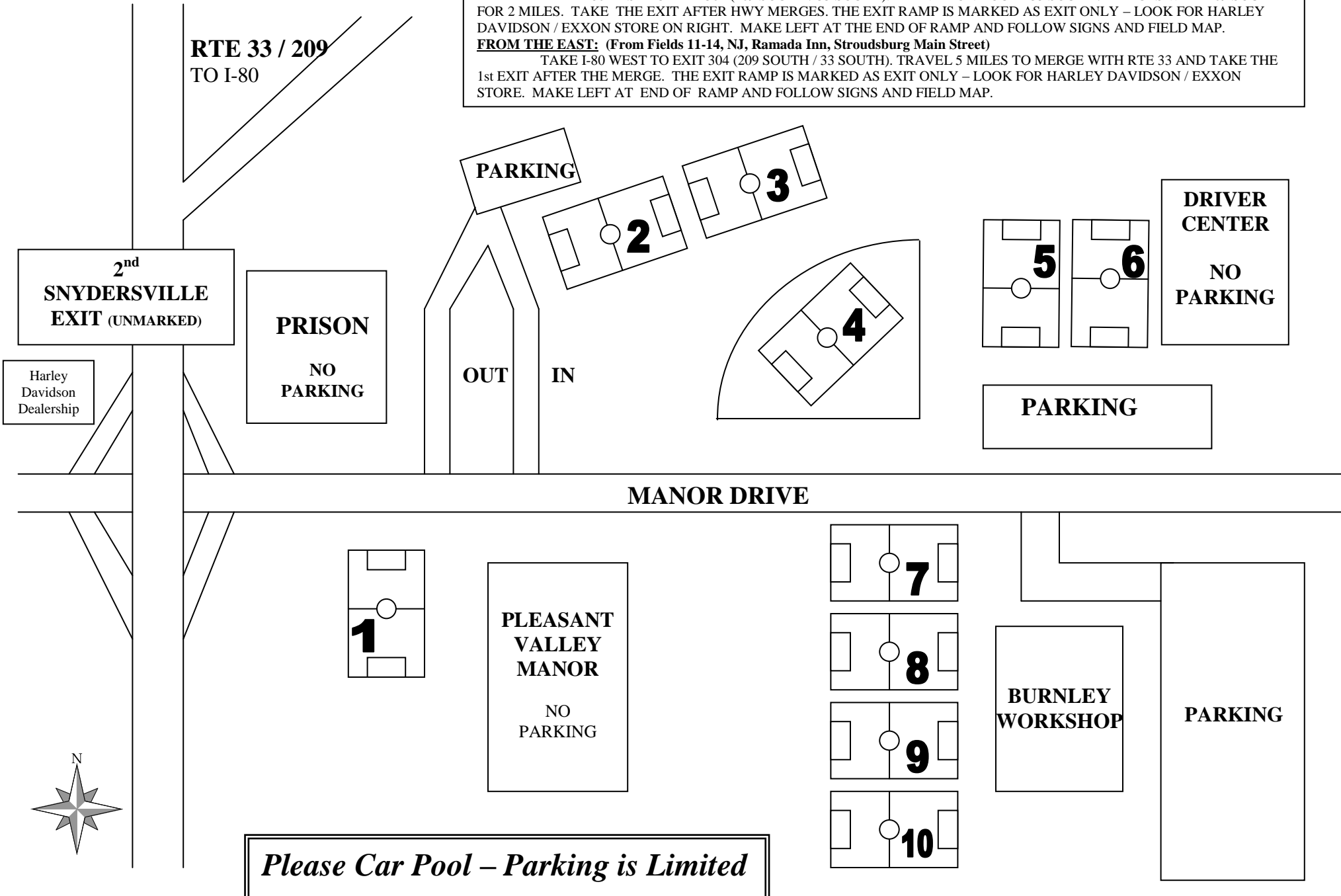

Please Car Pool – Parking is Limited

Fields 11, 11a, 12, 12a, 13, 14

Minisink Smithfield Twp. Park

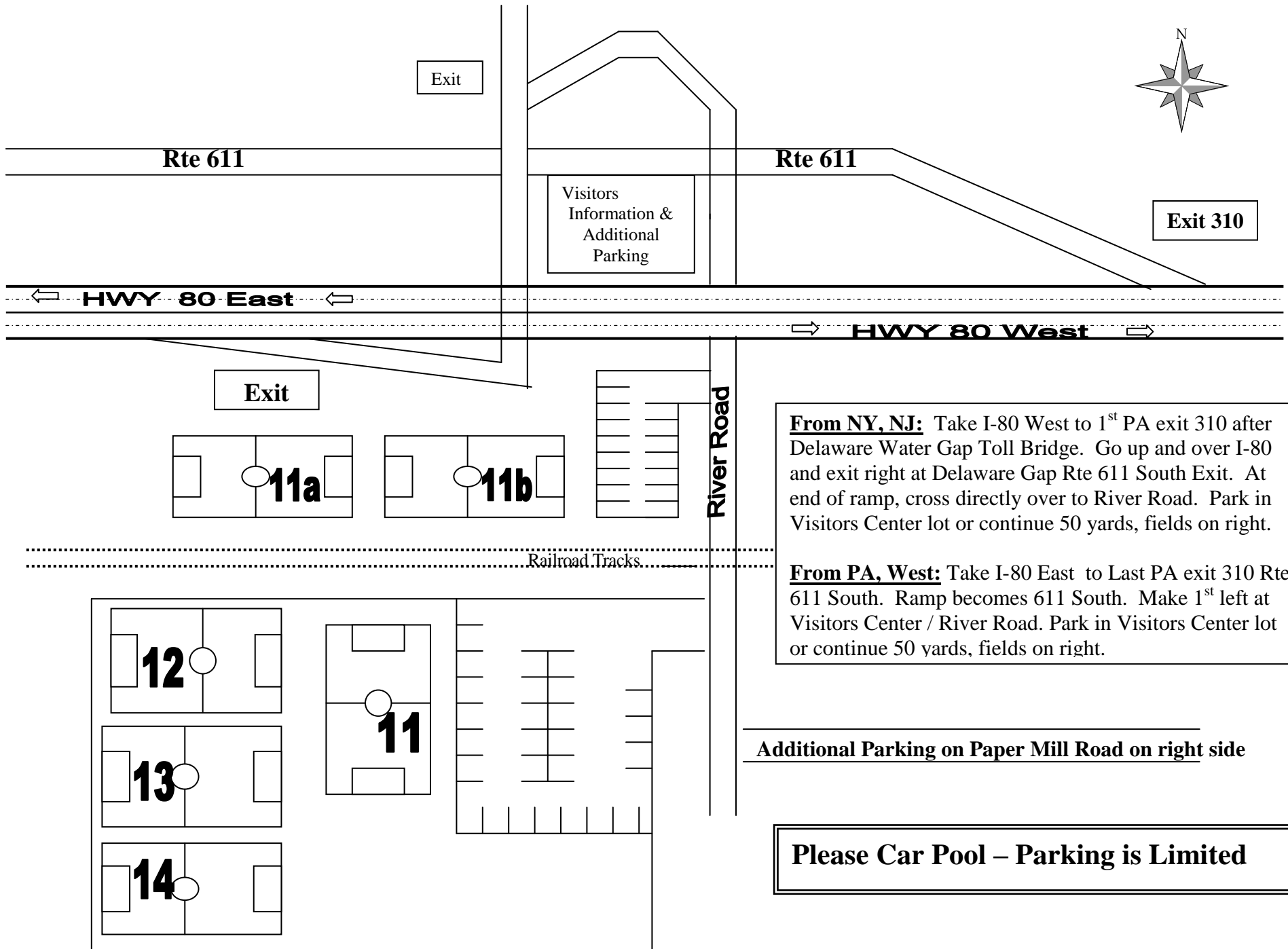

From NY, NJ: Take I-80 West to 1st PA exit 310 after Delaware Water Gap Toll Bridge. Go up and over I-80 and exit right at Delaware Gap Rte 611 South Exit. At end of ramp, cross directly over to River Road. Park in Visitors Center lot or continue 50 yards, fields on right.

From PA, West: Take I-80 East to Last PA exit 310 Rte 611 South. Ramp becomes 611 South. Make 1st left at Visitors Center / River Road. Park in Visitors Center lot or continue 50 yards, fields on right.

Additional Parking on Paper Mill Road on right side

Please Car Pool – Parking is Limited

East Stroudsburg University - POCONO CUP FIELD SITE

DIRECTIONS

Fields 18, 19, 20 & 20 A

FIELD 20

Interstate 80 East or West: Take East Stroudsburg University Exit # 308, Make a right at the end of the ramp on to Prospect Street, Make 1st right on to East Brown Street (Texaco Station), pass hospital and stadium, make 1st left on to South Smith Street (tennis courts), make a left on to Center Street, Field 20 is on the left in the outfield of the Baseball stadium.

Field 20 A – Stadium Turf Field next to Baseball Field (Field 20)

FIELDS 18 & 19

Interstate 80 East or West: Take East Stroudsburg University Exit # 308, Make a right at the end of the ramp on to Prospect Street, Make 1st right on to East Brown Street (Texaco Station), pass hospital and stadium, make 1st left on to South Smith Street (tennis courts), make right on to Normal Street (stop sign), go up hill and must make a left on Marguerite Street (stop sign – do not continue straight – this is a private road and cars will be towed by residents), make a right on to Mary Street, go up hill to the end and fields are on the right.

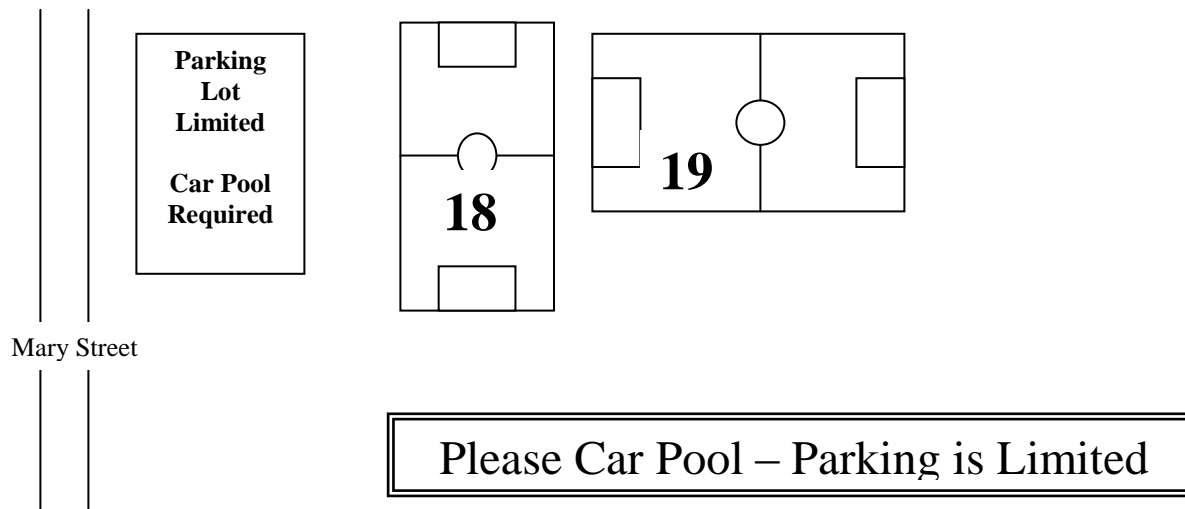

Fields 21-24

FROM THE WEST: (Chateau Resort, Mt. Pocono)

Take I-80 East to exit 302 (209 South / 33 South), travel 6 miles to the Lehighon 209 South Exit, follow 209 south for 5.5 miles to the Rte 115 junction, bear right at the fork onto Rte 115, travel 1/4 mile to Pleasant Valley School and fields will be on the left.

FROM THE EAST: (From Fields 11-20, NJ, Ramada Inn, Stroudsburg Main Street)

Take I-80 West to Exit 304 (209 South / 33 South), travel 6 miles to the Lehighon 209 South Exit, follow 209 south for 5.5 miles to the Rte 115 junction, bear right at the fork onto Rte 115, travel 1/4 mile to Pleasant Valley School and fields will be on the left.

FROM FILEDS 1-10:

Take Manor Drive to Rte 33 South, get on Rte 33 for 1 mile to the Lehighon 209 South Exit, follow 209 south for 5.5 miles to the Rte 115 junction, bear right at the fork onto Rte 115, travel 1/4 mile to Pleasant Valley School and fields will be on the left.

